



**Sürtünme Plakası / Sliding Pad**



**Not / Note**

Tüm Ağızları pah kırılacaklar  
Break all sharp edges  
Toleransız tüm ölçüler  
EN 22768-1 standardında  
All dimensions without tolerance  
as per EN 22768-1



Sipariş Kodu / Order Code  
**SPS43 - W - L**

**Malzeme / Material**

GG25 + Graphite

**Referans Kod / Reference Code**

AFNOR  
ISO 9183-2

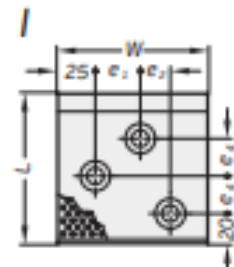
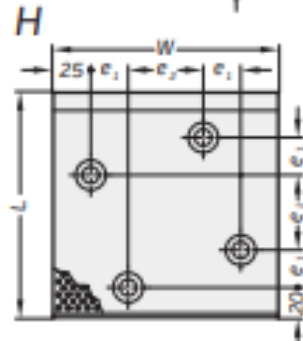
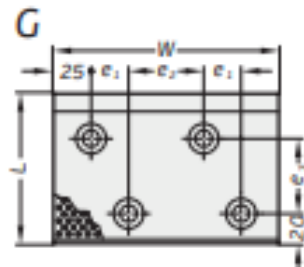
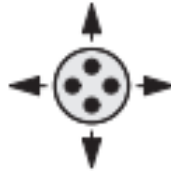
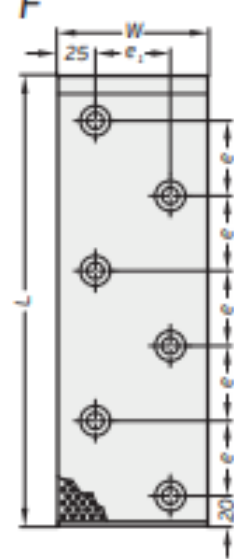
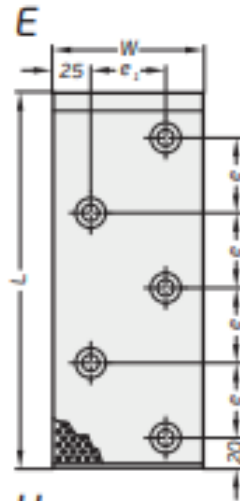
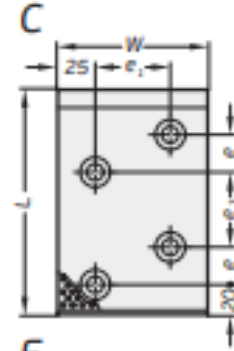
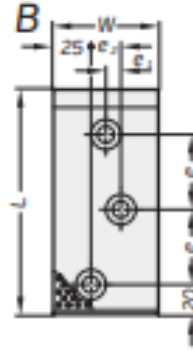
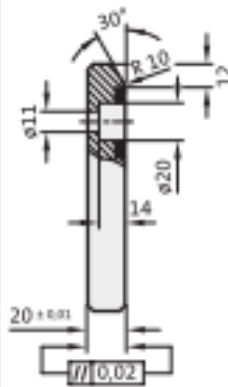
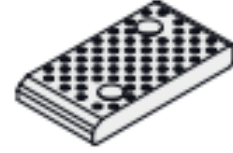

Sipariş Kodu / Order Code	Form	W	L	e	e <sub>1</sub>	e <sub>2</sub>	e <sub>3</sub>	e <sub>4</sub>	Çiviler/ Screws
SPS43-70-100	A	70	100	50	20	-	-	-	2
SPS43-70-150	B	70	150	50	10	20	-	-	3
SPS43-70-200	D	70	200	50	20	-	-	-	4
SPS43-100-100	I	100	100	-	30	20	-	25	3
SPS43-100-150	C	100	150	25	50	-	50	-	4
SPS43-100-200	D	100	200	50	50	-	-	-	4
SPS43-100-250	E	100	250	50	50	-	-	-	5
SPS43-100-300	F	100	300	50	50	-	-	-	6
SPS43-150-100	G	150	100	-	25	50	50	-	4
SPS43-150-150	H	150	150	-	25	50	-	-	4
SPS43-150-200	D	150	200	50	100	-	-	-	4
SPS43-150-250	E	150	250	50	100	-	-	-	5
SPS43-150-300	F	150	300	50	100	-	-	-	6
SPS43-200-100	G	200	100	-	50	50	50	-	4