

DAK-150 Bilgilendirme / Information

- Çalışma Kuvveti / Working Force : (300.000 Baskı/Stroke) 98,0 kN (10,0tonf)
- Sürücü Geniřliđi / Slider Width : 150 mm
- Çalışma Açısı / Work Angle : 0° ~ 20°
- 02 : CK45, 01 : GGG60 (Opsiyon) / 02 : CK45, 01 : GGG60 (Option)
- Sürtünme Plakası Opsiyonu / Wear Plate Option : P
- Gazlı Yay Opsiyonu / Gas Spring Option : GY
- Pim Deliđi Ø16H7 (Opsiyon) / Dowel Pin Ø16H7 (Option)
- Isıl İşlem Opsiyonu / Induction Option : I

Kam Diyagramı / Cam Diagram

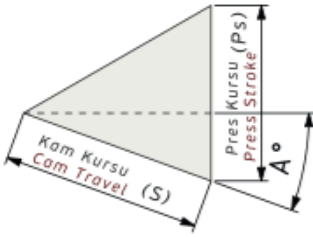

Sipariş Örneđi / Order Example

Kam Kodu Cam Code	Sürücü Geniřliđi Slider Width (mm)	Çalışma Açısı Work Angle (°)	Kurs Travel (mm)	Malzeme Material	Opsiyon Kodu / Option Code
	(G)	(A)	(S)	01 / 02	P-GY-F16-I Opsiyonları P-GY-F16-I Option
DAK -	150 -	05 -	45 -	01	
DAK -	150 -	10 -	70 -	02 -	P - GY
DAK -	150 -	20 -	70 -	01 -	P - GY - F16 - I

DAK-150 Teknik Bilgiler / Technical Informations

Çalışma Yüzeyi/Mounting Surface		Çalışma Açısı Work Angle (°)	Kam Kursu/Cam Travel Stroke (mm)	Çalışma Kuvveti Working Force	Yay Kuvveti Spring Force	Gazlı Yay Kuvveti Gas Spring Force (Opsiyon/Option)
(G)	(Gh)	(A)	(S)			
150	100	05	45	300.000 Baskı/Stroke 98,0 kN (10,0 tonf)	1803 N (184 kgf)	5194 N (530 kgf)
150	100	05	70		1842 N (188 kgf)	5194 N (530 kgf)
150	100	10	45	1.000.000 Baskı/Stroke 64,7 kN (6,6 tonf)	1803 N (184 kgf)	5194 N (530 kgf)
150	100	10	70		1842 N (188 kgf)	5194 N (530 kgf)
150	100	15	45		1803 N (184 kgf)	5194 N (530 kgf)
150	100	15	70		1842 N (188 kgf)	5194 N (530 kgf)
150	100	20	45		1803 N (184 kgf)	5194 N (530 kgf)
150	100	20	70		1842 N (188 kgf)	5194 N (530 kgf)

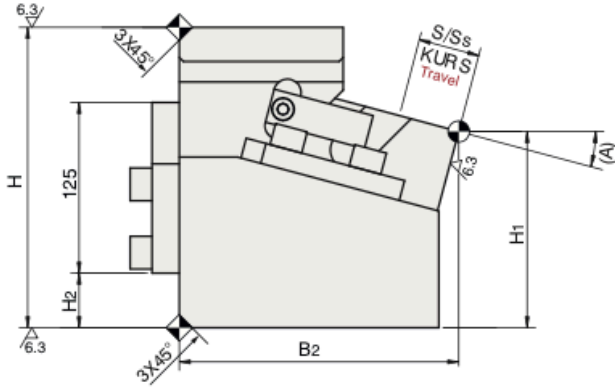
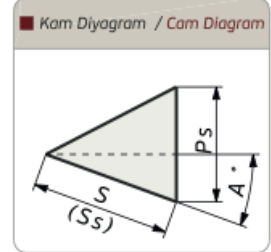
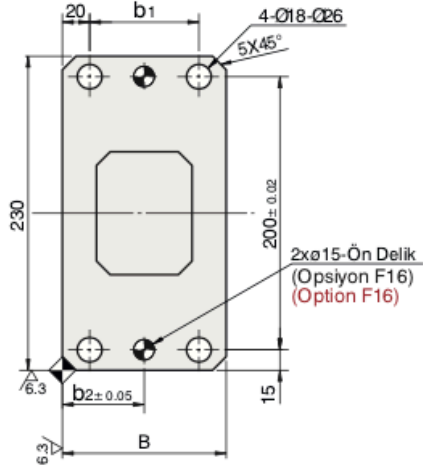

X,Y=0
Sürücü İşleme
Slider Milling

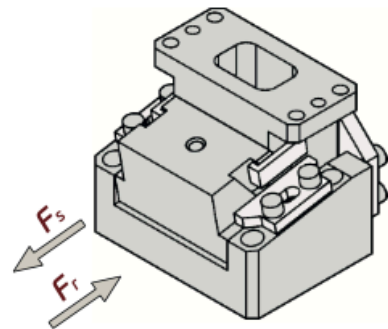
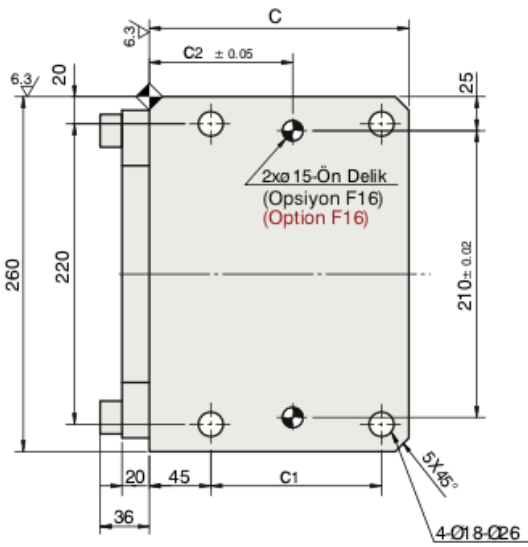
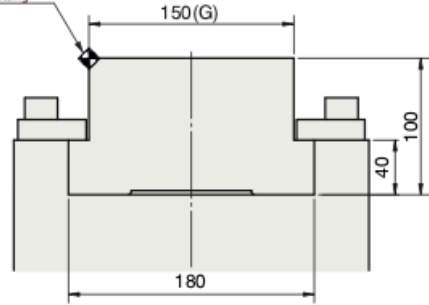

Kam Kodu Cam Kode	Açı Angle (A)	Ölçüler / Dimensions (mm)												
		S	Ps	Ss	H	H1	H2	B	B2	b1	b2	C	c1	c2
DAK-150	05	45	67,9	45	220	158,6	30	110	193,1	70	55	190	125	105
DAK-150	05	70	105,7	70	220	166,4	40	130	218,0	90	65	200	135	120
DAK-150	10	45	60,6	45	220	151,4	40	110	199,6	70	55	190	125	105
DAK-150	10	70	94,3	70	220	152,5	40	130	224,2	90	65	200	135	120
DAK-150	15	45	55,1	45	220	143,8	40	120	204,6	80	60	190	125	105
DAK-150	15	70	85,7	70	230	152,3	55	140	228,8	100	70	200	135	120
DAK-150	20	45	50,8	45	220	135,8	40	120	208,1	80	60	190	125	105
DAK-150	20	70	79,1	70	230	137,2	55	140	231,6	100	70	200	135	120

 Kod / Code	(G)	(A)	(S)	Opsiyon / Option
DAK	150	00	45	02/01 - P - F16 - GY - I