

AKUSV-85 Bilgilendirme / Information

- Çalışma Kuvveti / Working Force : (300.000 Baskı/Stroke) 98,0 kN (10,0tonf)
- Sürücü Genişliği / Slider Width : 85 mm
- Çalışma Açısı / Work Angle : 0° - 75°
- Pim Deliği Ø13H7 (Opsiyon) / Dowel Pin Ø13H7 (Option)
- Sipariş Örneği / Order Example : AKUSV-85-10-F13

Kam Diyagramı / Cam Diagram

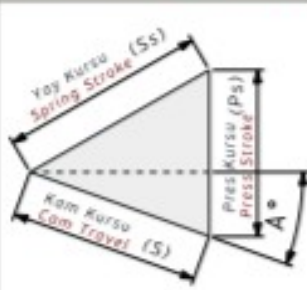

Sipariş Örneği / Order Example

| Kam Kodu Cam Code | Sürücü Genişliği Slider Width (mm) | Çalışma Açısı Work Angle (°) | Opsiyon Kodu / Option Code | | |
|----------------------|--|------------------------------------|----------------------------|-----|-----|
| | | | Pim Deliği Dowel Pin | --- | --- |
| AKUSV - | 85 | - 00 | | | |
| AKUSV - | 85 | - 45 | - F13 | | |

AKUSV-85 Teknik Bilgiler / Technical Informations

| Çalışma Yüzeyi/Mounting Surface | | Çalışma Açısı Work Angle (°) | Kam Kuruşu/Cam Travel Stroke (mm) | Çalışma Kuvveti Working Force | Yay Kuvveti Spring Force | Gazlı Yay Kuvveti Gas Spring Force |
|---------------------------------|------|---------------------------------|--------------------------------------|---|-----------------------------|---------------------------------------|
| (G) | (Gh) | | | | | |
| 85 | 110 | 00 | 19,3 | 300.000 Baskı/Stroke 98,0 kN (10,0 tonf) | | 6213 N (634 kgf) |
| 85 | 110 | 05 | 21,3 | | | 6213 N (634 kgf) |
| 85 | 110 | 10 | 23,3 | | | 6213 N (634 kgf) |
| 85 | 110 | 15 | 25,4 | | | 6213 N (634 kgf) |
| 85 | 110 | 20 | 27,6 | | | 6213 N (634 kgf) |
| 85 | 110 | 25 | 30,0 | | | 6213 N (634 kgf) |
| 85 | 110 | 30 | 32,6 | | | 6213 N (634 kgf) |
| 85 | 110 | 35 | 35,4 | | | 6213 N (634 kgf) |
| 85 | 110 | 40 | 38,6 | | | 6213 N (634 kgf) |
| 85 | 110 | 45 | 42,3 | | | 6213 N (634 kgf) |
| 85 | 110 | 50 | 46,7 | | | 6213 N (634 kgf) |
| 85 | 110 | 55 | 52,3 | | | 6213 N (634 kgf) |
| 85 | 110 | 60 | 60,0 | | | 6213 N (634 kgf) |
| 85 | 110 | 65 | 71,0 | | | 6213 N (634 kgf) |
| 85 | 110 | 70 | 58,5 | | | 6213 N (634 kgf) |
| 85 | 110 | 75 | 77,3 | | | 6213 N (634 kgf) |

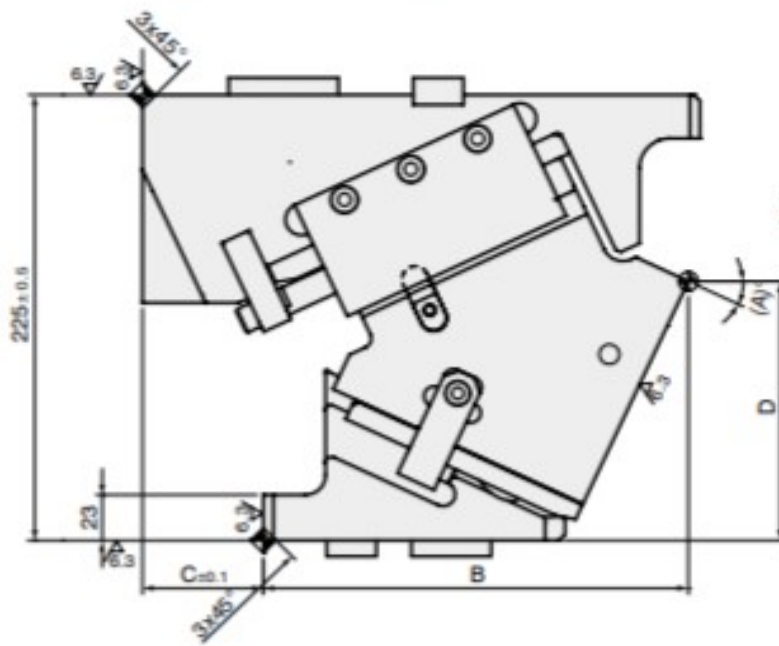
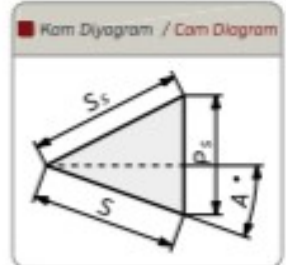
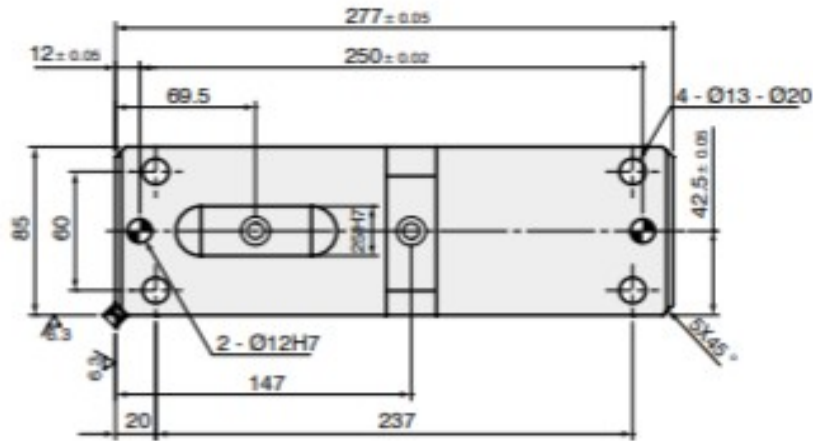

X,Y=0
Sirkül İşleme
Silindirik Alet

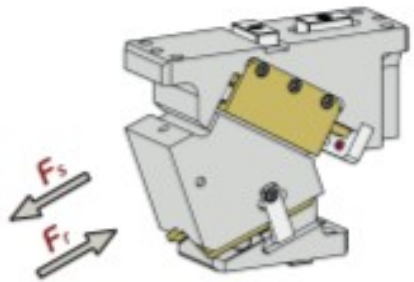
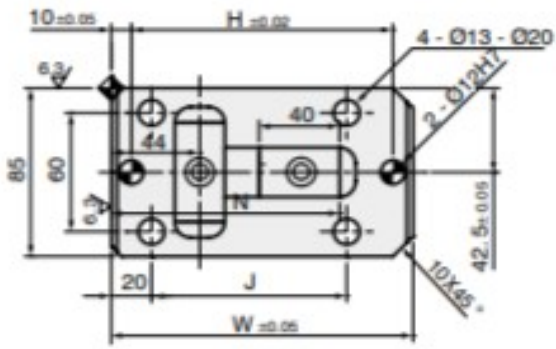
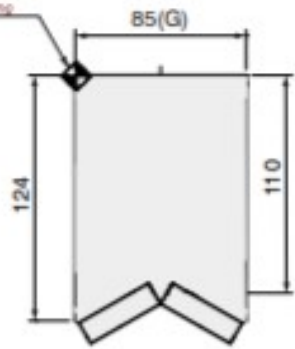

| Kam Kodu Cam Kode | Açı Angle (A) | Ölçüler / Dimensions (mm) | | | | | | | | | |
|----------------------|---------------------|---------------------------|----------------|----------------|--------|-----|--------|-----|----|-----|-------|
| | | S | P _s | S _s | B | C | D | H | J | W | N |
| AKUSV-85 | 00 | 19,3 | 23,0 | 30 | 152,00 | 115 | 162,00 | 130 | 97 | 150 | 113,5 |
| AKUSV-85 | 05 | 21,3 | 23,1 | 30 | 162,39 | 110 | 157,84 | 130 | 97 | 150 | 113,5 |
| AKUSV-85 | 10 | 23,3 | 23,3 | 30 | 174,07 | 101 | 153,23 | 130 | 97 | 150 | 113,5 |
| AKUSV-85 | 15 | 25,4 | 23,8 | 30 | 185,99 | 92 | 145,28 | 130 | 97 | 150 | 113,5 |
| AKUSV-85 | 20 | 27,6 | 24,5 | 30 | 204,08 | 69 | 136,57 | 130 | 97 | 150 | 113,5 |
| AKUSV-85 | 25 | 30,0 | 25,4 | 30 | 211,30 | 60 | 130,85 | 130 | 97 | 150 | 113,5 |
| AKUSV-85 | 30 | 32,6 | 26,5 | 30 | 217,61 | 52 | 124,74 | 130 | 97 | 150 | 113,5 |
| AKUSV-85 | 35 | 35,4 | 28,1 | 30 | 218,99 | 47 | 121,54 | 130 | 97 | 150 | 113,5 |
| AKUSV-85 | 40 | 38,6 | 30,0 | 30 | 225,39 | 37 | 114,47 | 120 | 87 | 140 | 106,5 |
| AKUSV-85 | 45 | 42,3 | 32,5 | 30 | 233,82 | 23 | 107,03 | 120 | 87 | 140 | 106,5 |
| AKUSV-85 | 50 | 46,7 | 35,8 | 30 | 229,24 | 20 | 91,52 | 110 | 77 | 130 | 96,5 |
| AKUSV-85 | 55 | 52,3 | 42,8 | 30 | 231,67 | 19 | 84,21 | 110 | 77 | 130 | 96,5 |
| AKUSV-85 | 60 | 60,0 | 52,0 | 30 | 236,10 | 4 | 75,65 | 110 | 77 | 130 | 96,5 |
| AKUSV-85 | 65 | 71,0 | 64,3 | 30 | 240,00 | -5 | 65,95 | 110 | 77 | 130 | 96,5 |
| AKUSV-85 | 70 | 58,5 | 54,9 | 20 | 245,00 | -15 | 56,12 | 110 | 80 | 130 | 96,5 |
| AKUSV-85 | 75 | 77,3 | 74,6 | 20 | 253,00 | -25 | 38,01 | 110 | 90 | 130 | 96,5 |

|  ORDER | Kod / Code | (G) | (A) | Opsiyon / Option |
|---|------------|-------|-----|------------------|
| | | AKUSV | 85 | 30 |