

AKUG-80 Bilgilendirme / Information

- Çalışma Kuvveti / Working Force : (300.000 Baskı/Stroke) 98,0 kN(10,0 tonf)
- Sürücü Genişliği / Slider Width : 80 mm
- Çalışma Açısı / Work Angle : 0° - 65°
- Gazlı Yay Opsiyon / Gas Spring Option : GY
- Pim Deliği Ø13H7 (Opsiyon) / Dowel Pin Ø13H7 Option
- Sipariş Örneği / Order Example : AKUG-80-05

Kam Diyagramı / Cam Diagram

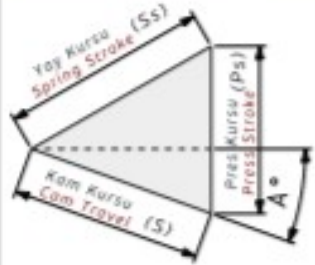

Sipariş Örneği / Order Example

Kam Kodu Cam Code	Sürücü Genişliği Slider Width (mm)	Çalışma Açısı Work Angle (°)	Opsiyon Kodu / Option Code			
			Gazlı Yay Gas Spring	Pim Deliği Dowel Pin	---	---
AKUG - 80	- 80	- 00				
AKUG - 80	- 80	- 30	- GY			
AKUG - 80	- 80	- 15	- GY	- F13		

AKUG-80 Teknik Bilgiler / Technical Informations

Çalışma Yüzeyi/Mounting Surface		Çalışma Açısı Work Angle (°)	Kam Kuruşu/Cam Travel Stroke (mm)	Çalışma Kuvveti Working Force	Yay Kuvveti Spring Force	Gazlı Yay Kuvveti Gas Spring Force (Opsiyon/Option)	
(G)	(Gh)						
80	90	00	30,2	300.000 Baskı/Stroke 98,0 kN (10,0 tonf)	1842 N (188 kgf)	2700 N (275 kgf)	
80	90	05	30,5		1872 N (191 kgf)	2700 N (275 kgf)	
80	90	10	31,1		1872 N (191 kgf)	2700 N (275 kgf)	
80	90	15	33,9		1872 N (191 kgf)	2700 N (275 kgf)	
80	90	20	32,3		1911 N (195 kgf)	2700 N (275 kgf)	
80	90	25	35,0		1911 N (195 kgf)	2700 N (275 kgf)	
80	90	30	34,7		1911 N (195 kgf)	2700 N (275 kgf)	
80	90	35	37,7		1911 N (195 kgf)	2700 N (275 kgf)	
80	90	40	39,9		1.000.000 Baskı/Stroke 49,0 kN (5,0 tonf)	1911 N (195 kgf)	2700 N (275 kgf)
80	90	45	43,7			1911 N (195 kgf)	2700 N (275 kgf)
80	90	50	46,7	1911 N (195 kgf)		2700 N (275 kgf)	
80	90	55	53,8	1911 N (195 kgf)		2700 N (275 kgf)	
80	90	60	61,1	1911 N (195 kgf)		2700 N (275 kgf)	
80	90	65	70,9		1911 N (195 kgf)	2700 N (275 kgf)	

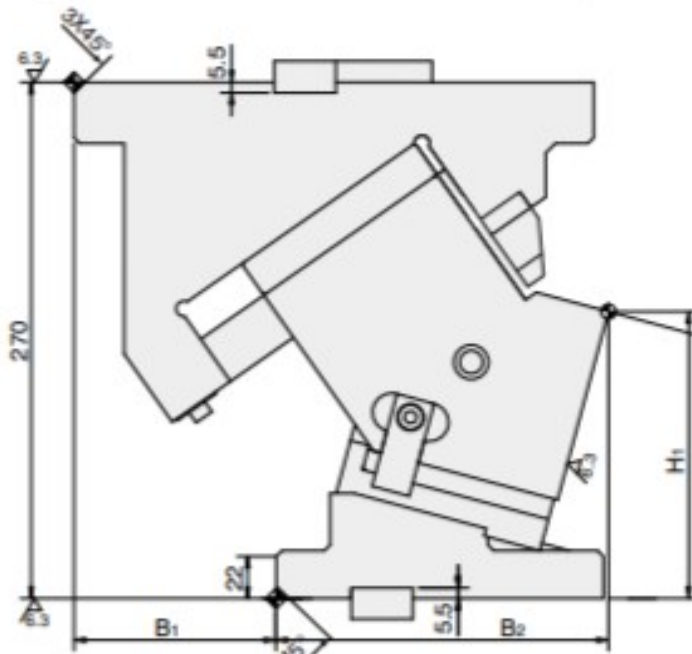
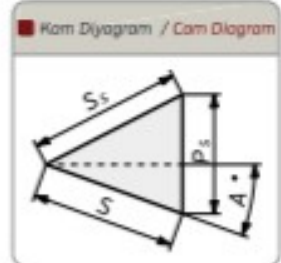
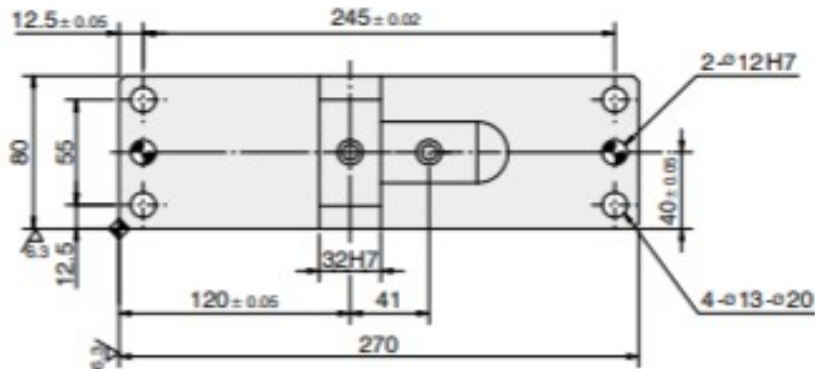

X,Y=0
Sırtıcı İşleme
Sırtıcı Mâkine

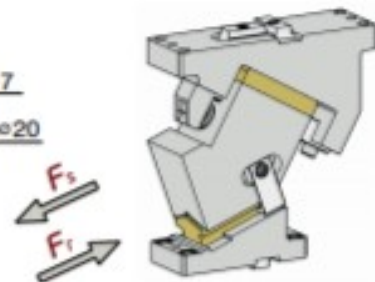
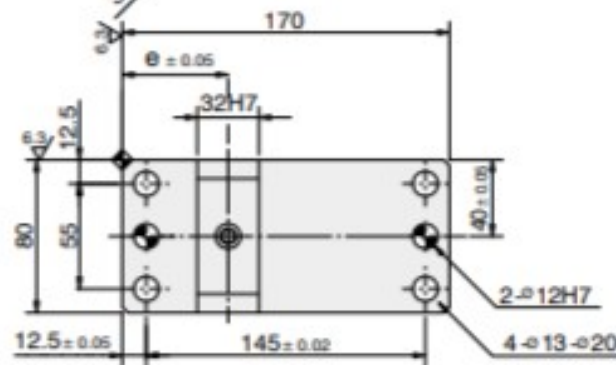
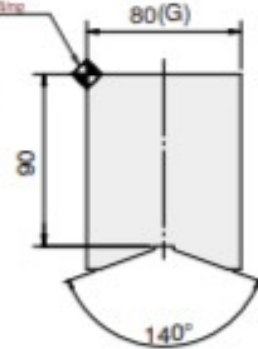

Kam Kodu Cam Kode	Açı Angle (A)	Ölçüler / Dimensions (mm)						
		S	P _s	S _s	H ₁	B ₁	B ₂	e
AKUG-80	00	30,2	36,0	47	160,0	135	142,0	65
AKUG-80	05	30,5	33,1	43	154,3	125	153,3	65
AKUG-80	10	31,1	31,1	40	152,7	110	164,5	65
AKUG-80	15	33,9	31,7	40	150,1	105	172,6	55
AKUG-80	20	32,3	28,5	35	146,5	95	178,3	55
AKUG-80	25	35,0	29,6	35	142,0	80	188,8	55
AKUG-80	30	34,7	28,3	32	136,6	65	196,7	60
AKUG-80	35	37,7	29,9	32	130,3	55	203,2	60
AKUG-80	40	39,9	31,0	31	123,3	35	210,1	50
AKUG-80	45	43,7	33,6	31	115,5	30	215,3	50
AKUG-80	50	46,7	35,8	30	107,0	0	220,9	50
AKUG-80	55	53,8	41,4	31	97,9	0	229,6	60
AKUG-80	60	61,1	47,5	31	88,3	-20	228,6	50
AKUG-80	65	70,9	56,2	31	78,1	-30	233,7	50

 ORDER	Kod / Code	(G)	(A)	Opsiyon / Option
	AKUG	80	05	GY - F13