

**AKUG-300 Bilgilendirme / Information**

- Çalışma Kuvveti / Working Force : (300.000 Baskı/Stroke) 588,0kN(60,0tonf)
- Sürücü Genişliği / Slider Width : 300 mm
- Çalışma Açısı / Work Angle : 0° - 65°
- Gazlı Yay Opsiyon / Gas Spring Option : GY
- Sipariş Örneği / Order Example : AKUG-300-25

**Kam Diyagramı / Cam Diagram**

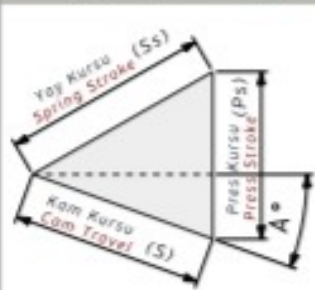

**Sipariş Örneği / Order Example**

Kam Kodu Cam Code	Sürücü Genişliği Slider Width (mm)	Çalışma Açısı Work Angle (°)	Opsiyon Kodu / Option Code			
			Gazlı Yay Gas Spring	Pim Deliği Dowel Pin	---	---
AKUG - 300 - 00						
AKUG - 300 - 05 - GY						

**AKUG-300 Teknik Bilgiler / Technical Informations**

Çalışma Yüzeyi/Mounting Surface		Çalışma Açısı Work Angle (°)	Kam Kuruşu/Cam Travel Stroke (mm)	Çalışma Kuvveti Working Force	Yay Kuvveti Spring Force	Gazlı Yay Kuvveti Gas Spring Force (Opsiyon/Option)
(G)	(Gh)					
300	160	00	28,6		14045N(1432kgf)	27500 N (2800 kgf)
300	160	05	32,2		14045N(1432kgf)	27500 N (2800 kgf)
300	160	10	35,9		14045N(1432kgf)	27500 N (2800 kgf)
300	160	15	39,6	300.000 Baskı/Stroke 588,0 kN (60,0 tonf)	14045N(1432kgf)	27500 N (2800 kgf)
300	160	20	43,5		14045N(1432kgf)	27500 N (2800 kgf)
300	160	25	47,7		14045N(1432kgf)	27500 N (2800 kgf)
300	160	30	52,3		14045N(1432kgf)	27500 N (2800 kgf)
300	160	35	57,3		14045N(1432kgf)	27500 N (2800 kgf)
300	160	40	63,0	1.000.000 Baskı/Stroke 294,0 kN (30,0 tonf)	14045N(1432kgf)	27500 N (2800 kgf)
300	160	45	69,6		14045N(1432kgf)	27500 N (2800 kgf)
300	160	50	77,4		14045N(1432kgf)	27500 N (2800 kgf)
300	160	55	87,1		14045N(1432kgf)	27500 N (2800 kgf)
300	160	60	99,6		14045N(1432kgf)	27500 N (2800 kgf)
300	160	65	116,5		14045N(1432kgf)	27500 N (2800 kgf)

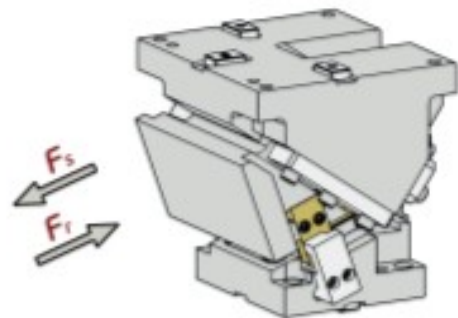
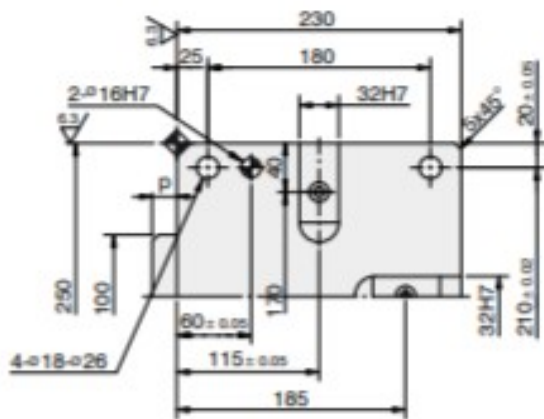
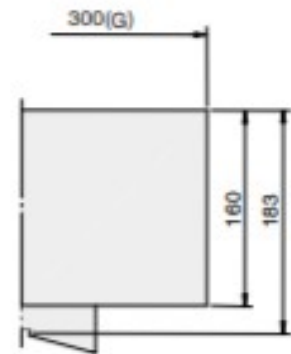
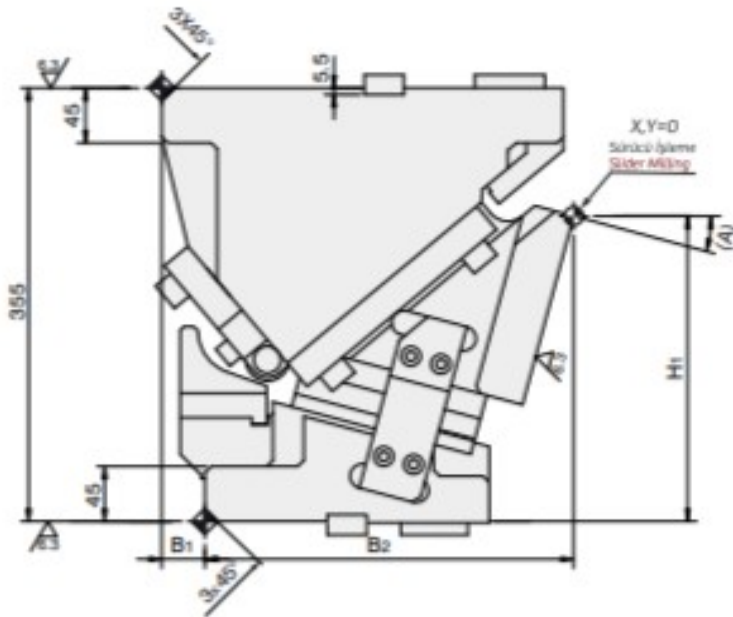
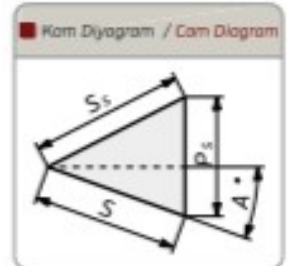
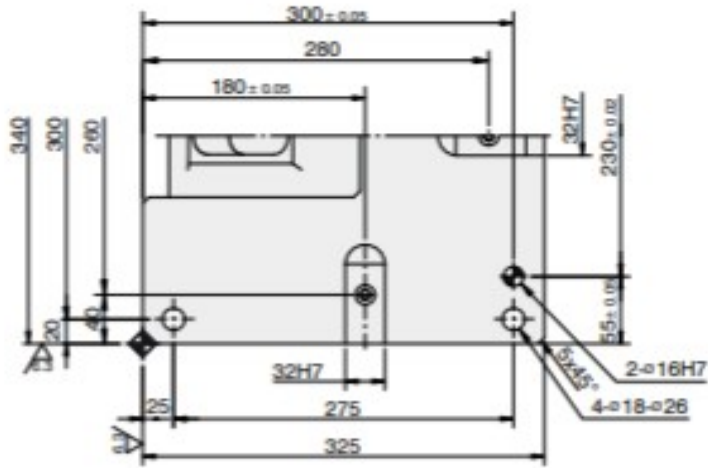

Kam Kodu Cam Kode	Açı Angle (A)	Ölçüler / Dimensions (mm)						
		S	Ps	Ss	H1	B1	B2	p
AKUG-300	00	28,6	40,9	50	265,0	80	245,0	25
AKUG-300	05	32,2	41,1	50	261,6	60	263,2	25
AKUG-300	10	35,9	41,5	50	256,6	45	281,0	25
AKUG-300	15	39,6	42,4	50	250,1	35	298,3	20
AKUG-300	20	43,5	43,5	50	242,1	25	315,0	15
AKUG-300	25	47,7	45,1	50	232,7	15	330,9	10
AKUG-300	30	52,3	47,2	50	221,9	0	346,0	-
AKUG-300	35	57,3	50	50	194,8	-15	360,0	-
AKUG-300	40	63,0	53,4	50	181,6	-35	373,0	-
AKUG-300	45	69,6	57,9	50	167,3	-50	384,7	-
AKUG-300	50	77,4	63,7	50	152,0	-70	395,2	-
AKUG-300	55	87,1	71,4	50	135,9	-90	404,2	-
AKUG-300	60	99,6	81,9	50	119,0	-105	411,9	-
AKUG-300	65	116,5	96,9	50	101,6	-120	418,0	-

 ORDER	Kod / Code	(G)	(A)
		AKUG	300