

AKUC-50 Bilgilendirme / Information

- Çalışma Kuvveti / Working Force : (300.000 Baskı/Stroke) 39,2 kN (4,0tonf)
- Sürücü Genişliği / Slider Width : 50 mm
- Çalışma Açısı / Work Angle : 0° – 70°
- Gazlı Yay Opsiyonu / Gas Spring Option : GY
- SU Opsiyonu / SU Option : 1–60 mm
- SG Opsiyonu / SG Option : 51–65 mm
- Pim Deliği Ø13H7 (Opsiyon) / Dowel Pin Ø13H7 (Option)
- Sipariş Örneği / Order Example : AKUC-50-10-SU25

Kam Diyagramı / Cam Diagram

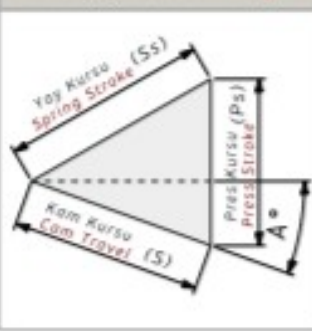

Sipariş Örneği / Order Example

Kam Kodu Cam Code	Sürücü Genişliği Slider Width (mm)	Çalışma Açısı Work Angle (°)	Opsiyon Kodu / Option Code			
			Sürücü Luzunluğu Slider Length	Sürücü Genişliği Slider Width	Gazlı Yay Gas Spring	Pim Deliği Dowel Pin
AKUC - 50	(G)	(A)				
AKUC - 50	50	00				
AKUC - 50	50	35			SU50	
AKUC - 50	50	20	SU50	SG60	GY	F13

AKUC-50 Teknik Bilgiler / Technical Informations

Çalışma Yüzeyi/Mounting Surface		Çalışma Açısı Work Angle (°)	Kam Kuruşu/Cam Travel Stroke (mm)	Çalışma Kuvveti Working Force	Yay Kuvveti Spring Force	Gazlı Yay Kuvveti Gas Spring Force (Opsiyon/Option)
(G)	(Gh)					
50	75	00	30,2		981 N (100 kgf)	2520 N (260 kgf)
50	75	05	30,5		981 N (100 kgf)	2520 N (260 kgf)
50	75	10	30,3		981 N (100 kgf)	2520 N (260 kgf)
50	75	15	30,5		981 N (100 kgf)	2520 N (260 kgf)
50	75	20	30,5	300.000 Baskı/Stroke	981 N (100 kgf)	2520 N (260 kgf)
50	75	25	30,0	39,2 kN (4,0 tonf)	981 N (100 kgf)	2520 N (260 kgf)
50	75	30	32,6		981 N (100 kgf)	2520 N (260 kgf)
50	75	35	35,4		981 N (100 kgf)	2520 N (260 kgf)
50	75	40	38,6		981 N (100 kgf)	2520 N (260 kgf)
50	75	45	42,3	1.000.000 Baskı/Stroke	981 N (100 kgf)	2520 N (260 kgf)
50	75	50	46,7	19,6 kN (2,0 tonf)	981 N (100 kgf)	2520 N (260 kgf)
50	75	55	52,1		981 N (100 kgf)	2520 N (260 kgf)
50	75	60	59,1		981 N (100 kgf)	2520 N (260 kgf)
50	90	65	58,3		981 N (100 kgf)	2520 N (260 kgf)
50	92	70	57,6		981 N (100 kgf)	2520 N (260 kgf)

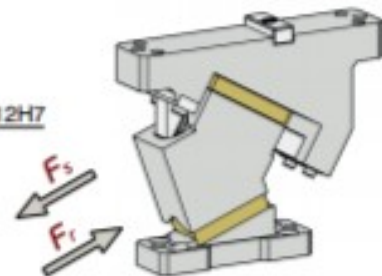
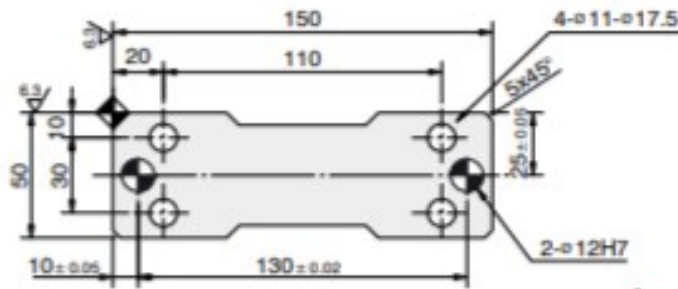
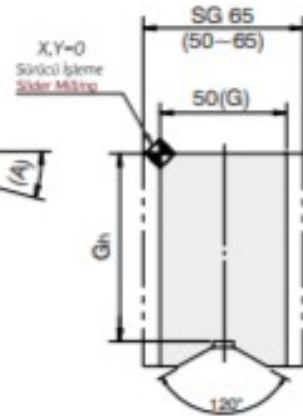
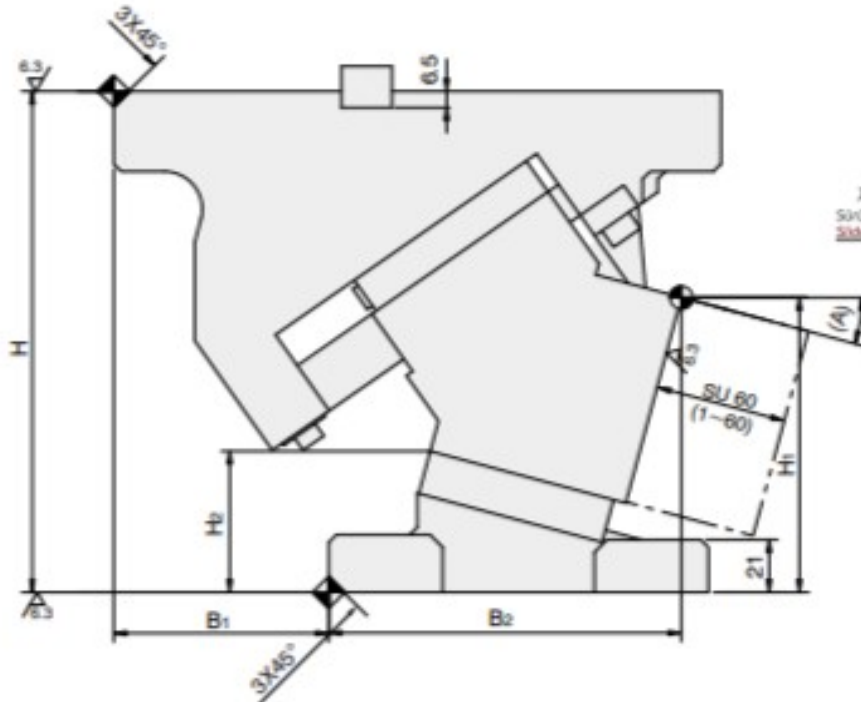
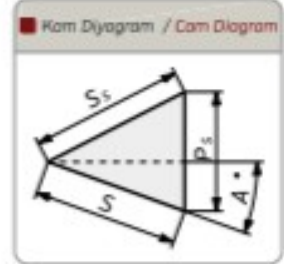
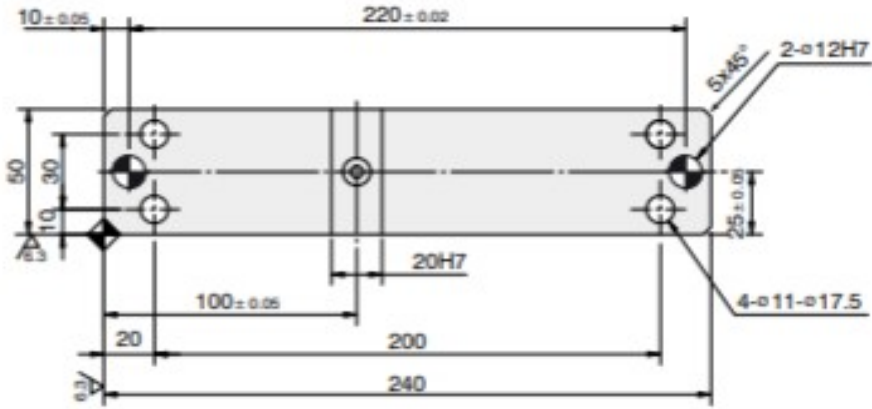

Kam Kodu Cam Kode	Açı Angle (A)	Ölçüler / Dimensions (mm)								
		S	Ps	Ss	H	H1	H2	B1	B2	Gh
AKUC-50	00	30,2	36,0	47	180	122,5	45,0	107	118,0	75
AKUC-50	05	30,5	33,1	43	180	121,7	51,4	100	126,9	75
AKUC-50	10	30,3	30,3	39	180	120,1	57,6	90	133,7	75
AKUC-50	15	30,5	28,6	36	180	117,7	63,6	85	139,4	75
AKUC-50	20	30,5	26,9	33	180	114,6	69,1	70	150,8	75
AKUC-50	25	30,0	25,4	30	180	110,8	74,4	58	157,9	75
AKUC-50	30	32,6	26,5	30	180	105,3	78,2	55	158,6	75
AKUC-50	35	35,4	28,1	30	180	103,1	85,5	35	169,9	75
AKUC-50	40	38,6	30,0	30	180	97,3	89,4	30	176,7	75
AKUC-50	45	42,3	32,5	30	180	96,9	98,7	20	182,0	75
AKUC-50	50	46,7	35,8	30	190	94,1	105,5	10	185,7	75
AKUC-50	55	52,1	40,1	30	190	83,7	104,8	0	189,8	75
AKUC-50	60	59,1	46,0	30	210	74,9	105,5	-15	194,3	75
AKUC-50	65	58,3	48,5	25	210	73,1	106,5	-32	208,6	90
AKUC-50	70	57,6	50,6	20	210	64,2	107,0	-38	215,0	92

 ORDER	Kod / Code	(G)	(A)	Opsiyon / Option
	AKUC	50	10	SU20 - SG55 - F13 - GY