

AKSB-200 Bilgilendirme / Information

- Çalışma Kuvveti / Working Force : (300.000 Baskı/Stroke)235,2kN(24,0 tonf)
- Sürücü Geniřliđi / Slider Width : 200 mm
- Çalışma Açısı / Work Angle : 0° ~ 60°
- Pim Deliđi F16 (Opsiyon) / Dowel Pin F16 (Option)
- Gazlı Yay Opsiyon / Gas Spring Option : GY
- Sipariř Örneđi / Order Example : AKSB-200-50-F16

Kam Diyagram / Cam Diagram

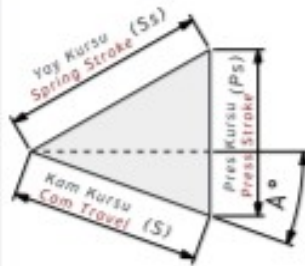

Sipariř Örneđi / Order Example

Kam Kodu Cam Code	Sürücü Geniřliđi Slider Width (mm)	Çalışma Açısı Work Angle (°)	Opsiyon Kodu / Option Code			
			Gazlı Yay Gas Spring	Pim Deliđi Dowel Pin	---	---
AKSB - 200 - 00						
AKSB - 200 - 10 - GY						
AKSB - 200 - 10 - GY - F16						

AKSB-200 Teknik Bilgiler / Technical Informations

Çalışma Yüzeyi/Mounting Surface		Çalışma Açısı Work Angle (°)	Kam Kuruřu/Cam Travel Stroke (mm)	Çalışma Kuvveti Working Force	Yay Kuvveti Spring Force	Gazlı Yay Kuvveti Gas Spring Force (Opsiyon/Option)
(G)	(Gh)					
200	180	00	38,6	300.000 Baskı/Stroke 235,2 kN (24,0 tonf)	4900 N (500 kgf)	8820 N (900 kgf)
200	180	05	42,6		4900 N (500 kgf)	8820 N (900 kgf)
200	180	10	46,7		4900 N (500 kgf)	8820 N (900 kgf)
200	180	15	50,9		4900 N (500 kgf)	8820 N (900 kgf)
200	180	20	55,3		4900 N (500 kgf)	8820 N (900 kgf)
200	180	25	60,0		4900 N (500 kgf)	8820 N (900 kgf)
200	180	30	65,1		4900 N (500 kgf)	8820 N (900 kgf)
200	180	35	70,8		4900 N (500 kgf)	8820 N (900 kgf)
200	180	40	77,1	1.000.000 Baskı/Stroke 117,6 kN (12,0 tonf)	4900 N (500 kgf)	8820 N (900 kgf)
200	180	45	84,5		4900 N (500 kgf)	8820 N (900 kgf)
200	180	50	93,3		4900 N (500 kgf)	8820 N (900 kgf)
200	180	55	104,6		4900 N (500 kgf)	8820 N (900 kgf)
200	180	60	120,0		4900 N (500 kgf)	8820 N (900 kgf)

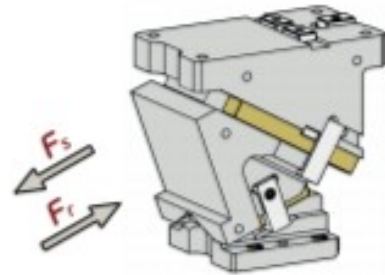
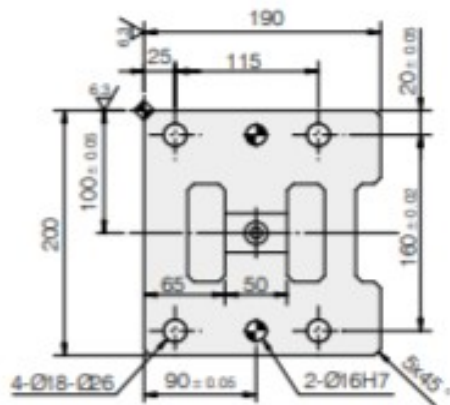
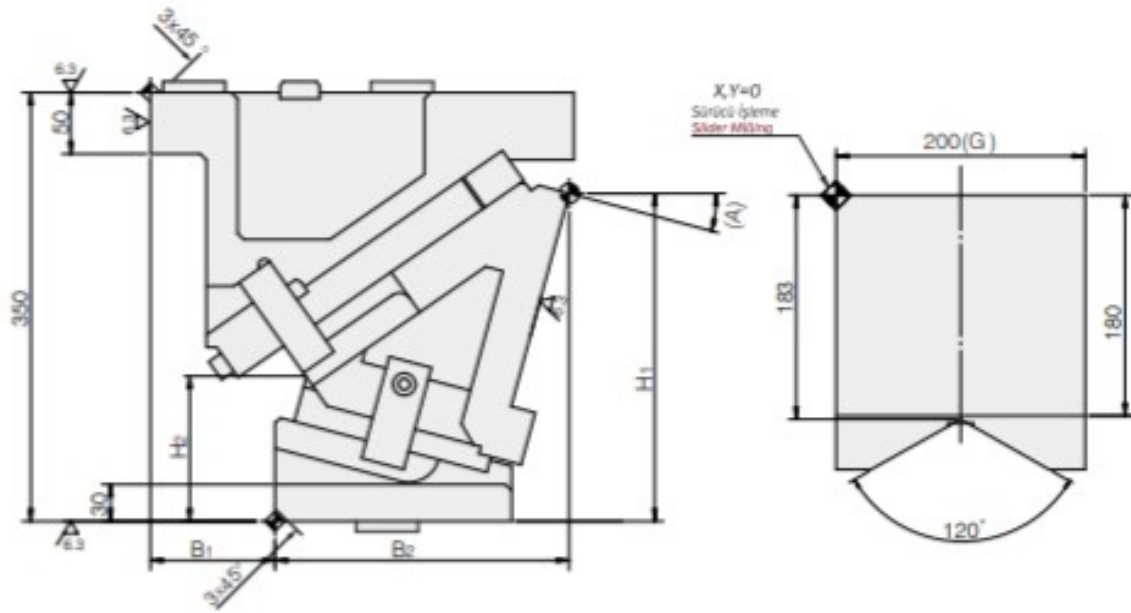
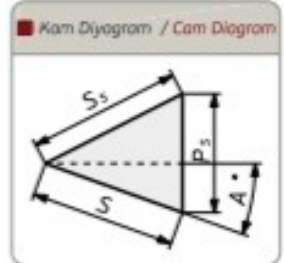
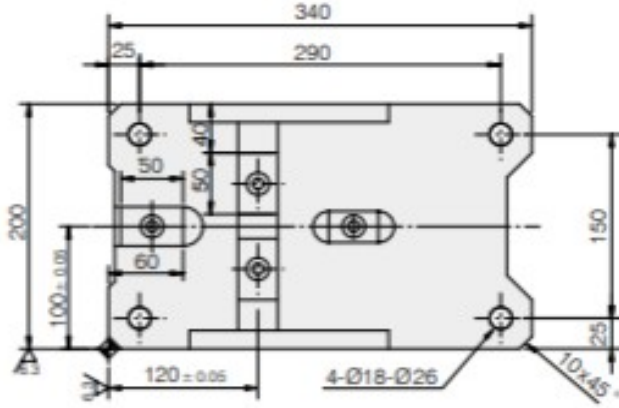

Kam Kodu Cam Kode	Açı Angle (A)	Ölçüler / Dimensions (mm)						
		S	Ps	Ss	H1	H2	B1	B2
AKSB-200	00	38,6	46,0	60	292,0	102,0	138	175,0
AKSB-200	05	42,6	46,1	60	285,7	110,8	125	195,6
AKSB-200	10	46,7	46,7	60	277,5	119,1	115	216,1
AKSB-200	15	50,9	47,5	60	267,6	126,8	100	236,2
AKSB-200	20	55,3	48,9	60	256,0	133,9	85	255,8
AKSB-200	25	60,0	50,7	60	247,7	145,2	70	274,7
AKSB-200	30	65,1	53,1	60	237,7	155,7	55	292,8
AKSB-200	35	70,8	56,1	60	226,3	165,3	45	310,0
AKSB-200	40	77,1	60,0	60	213,3	173,9	25	326,2
AKSB-200	45	84,5	65,0	60	199,1	181,4	15	341,1
AKSB-200	50	93,3	71,5	60	188,5	192,8	-6	354,8
AKSB-200	55	104,6	85,7	60	171,8	198,0	-15	367,0
AKSB-200	60	120,0	103,9	60	154,2	202,1	-45	377,8

  ORDER	Kod / Code	(G)	(A)	Opsiyon / Option
	AKSB	200	10	F16 - GY