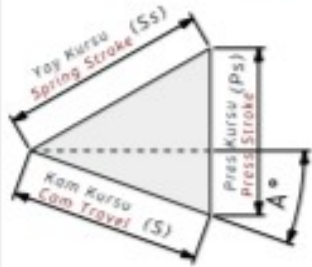

**AKHV-500 Bilgilendirme / Information**

- Çalışma Kuvveti / Working Force : (300.000 Baskı/Stroke) 1155 kN(119 tonf)
- Sürücü Genişliği / Slider Width : 500 mm
- Çalışma Açısı / Work Angle : 0° - 75°
- Sipariş Örneği / Order Example : AKHV-500-05

**Kam Diyagramı / Cam Diagram**

**Sipariş Örneği / Order Example**

Kam Kodu Cam Code	Sürücü Genişliği Slider Width mm	Çalışma Açısı Work Angle °	Opsiyon Kodu / Option Code			
	(G)	(A)	---	---	---	---
AKHV	500	25				

**AKHV-500 Teknik Bilgiler / Technical Informations**

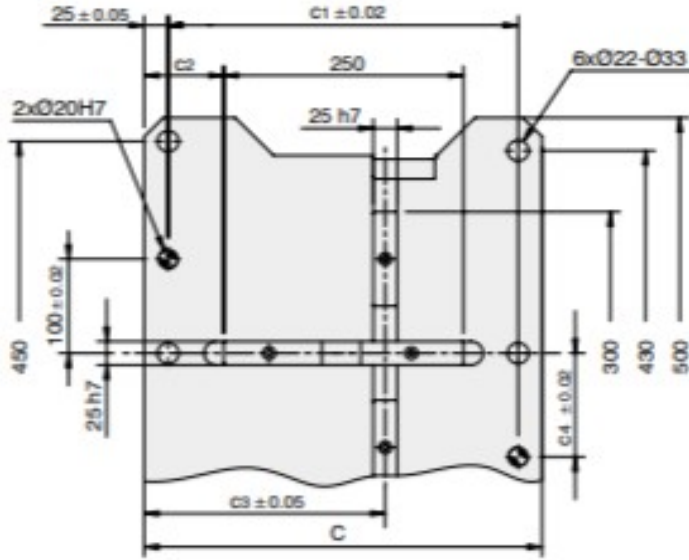
Çalışma Yüzeyi/Mounting Surface		Çalışma Açısı Work Angle (°)	Kam Kuruşu/Cam Travel Stroke (mm)	Çalışma Kuvveti Working Force	Yay Kuvveti Spring Force	Gazlı Yay Kuvveti Gas Spring Force
(G)	(Gh)	(A)	(S)			
500	180	00	37,3	300.000 Baskı/Stroke 1155,0 kN (119,0 tonf)		85750 N (8750 kgf)
500	180	05	41,2			85750 N (8750 kgf)
500	180	10	41,6			88200 N (9000 kgf)
500	180	15	46,0			88200 N (9000 kgf)
500	180	20	50,6			88200 N (9000 kgf)
500	180	25	52,4			86436 N (8820 kgf)
500	180	30	58,0			86436 N (8820 kgf)
500	180	35	61,3			77714 N (7930 kgf)
500	180	40	68,6			77714 N (7930 kgf)
500	180	45	74,3			73500 N (7500 kgf)
500	180	50	84,8			73500 N (7500 kgf)
500	180	55	95,0			69580 N (7100 kgf)
500	180	60	112,0			69580 N (7100 kgf)
500	180	65	102,9			65170 N (6650 kgf)
500	180	70	127,1			59290 N (6050 kgf)
500	180	75	114,2			58800 N (6000 kgf)



**Kam Diyagramı / Cam Diagram**

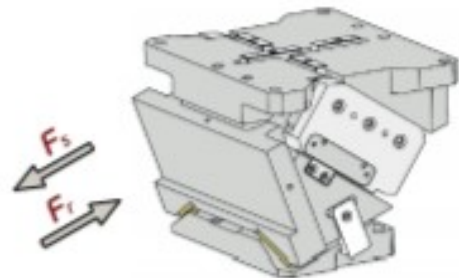
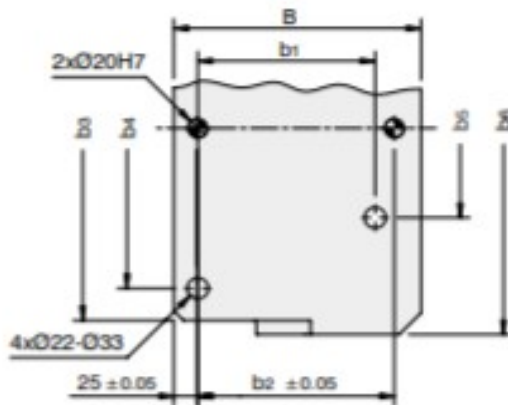
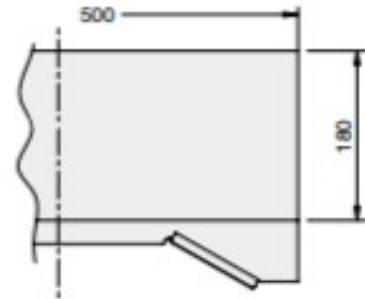
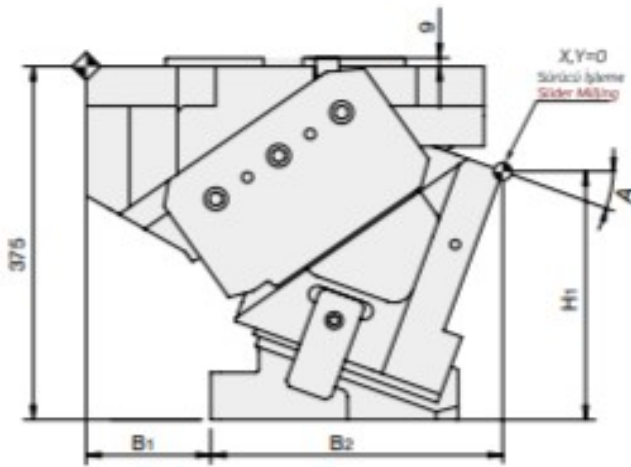
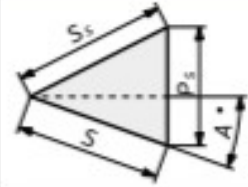

Kam Kodu Cam Kode	Açı Angle (A)	Ölçüler / Dimensions (mm)								
		S	P <sub>s</sub>	S <sub>s</sub>	H <sub>1</sub>	B	B <sub>1</sub>	B <sub>2</sub>	b <sub>1</sub>	b <sub>2</sub>
AKHV-500	00	37,3	44,4	58	300,0	266	130	273,0	185	205
AKHV-500	05	41,2	44,6	58	280,7	268	130	280,9	185	205
AKHV-500	10	41,6	48,2	58	275,7	254	130	288,8	185	205
AKHV-500	15	46,0	49,2	58	270,0	255	130	296,7	185	205
AKHV-500	20	50,6	50,6	58	263,7	246	130	329,5	185	205
AKHV-500	25	52,4	55,4	58	256,6	259	80	337,2	145	175
AKHV-500	30	58,0	58,0	58	243,9	250	80	344,6	145	175
AKHV-500	35	61,3	64,2	58	224,9	237	80	347,8	145	175
AKHV-500	40	68,6	68,6	58	216,7	232	80	358,7	145	175
AKHV-500	45	74,3	77,1	58	202,1	225	30	365,2	145	175
AKHV-500	50	84,8	84,8	58	186,7	215	30	382,7	145	175
AKHV-500	55	95,0	97,7	58	162,9	226	30	393,2	145	175
AKHV-500	60	112,0	112,0	58	142,9	228	30	403,6	145	175
AKHV-500	65	102,9	104,9	45	132,4	245	0	434,6	140	175
AKHV-500	70	127,1	131,1	45	120,5	219	0	429,9	125	175
AKHV-500	75	114,2	115,5	30	112,5	208	0	418,5	105	160

Kam Kodu Cam Kode	Açı Angle (A)	Ölçüler / Dimensions (mm)								
		b <sub>3</sub>	b <sub>4</sub>	b <sub>5</sub>	b <sub>6</sub>	C	c <sub>1</sub>	c <sub>2</sub>	c <sub>3</sub>	c <sub>4</sub>
AKHV-500	00	408	340	190	438	415	365	83,0	209,5	110
AKHV-500	05	408	340	190	438	415	365	83,0	220,0	110
AKHV-500	10	408	340	190	438	415	365	83,0	230,5	110
AKHV-500	15	408	340	190	438	415	365	83,0	241,0	110
AKHV-500	20	408	340	190	438	415	365	83,0	226,5	110
AKHV-500	25	408	340	190	438	415	365	83,0	237,0	110
AKHV-500	30	408	340	190	438	415	365	83,0	247,5	170
AKHV-500	35	408	340	190	438	415	365	83,0	256,5	110
AKHV-500	40	408	340	190	438	415	365	83,0	265,5	110
AKHV-500	45	408	340	190	438	450	401	103,0	224,5	110
AKHV-500	50	408	340	190	438	450	401	100,5	233,5	110
AKHV-500	55	408	340	190	438	450	401	100,5	240,9	110
AKHV-500	60	408	340	190	438	450	401	100,5	248,5	110
AKHV-500	65	500	463	463	500	450	401	100,5	248,5	110
AKHV-500	70	500	463	463	500	450	401	100,5	248,5	110
AKHV-500	75	500	463	463	500	450	401	100,5	233,5	110

	<b>Kod / Code</b>	<b>(G)</b>	<b>(A)</b>
	AKHV	500	20