

ACKSK-58 Bilgilendirme / Information

- Çalışma Kuvveti / Working Force : (300.000 Baskı/Stroke) 68,6 kN (7,0tonf)
- Sürücü Genişliği / Slider Width : 58 mm
- Çalışma Açısı / Work Angle : 0° – 80°
- SU Opsiyonu / SU Option : 1–60 mm
- SG Opsiyonu / SG Option : 59–65
- Sipariş Örneği / Order Example : ACKSK-58-10-SU25

Kam Diyagramı / Cam Diagram

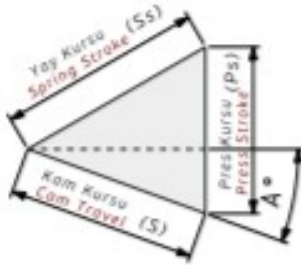

Sipariş Örneği / Order Example

Kam Kodu Cam Code	Sürücü Genişliği Slider Width mm	Çalışma Açısı Work Angle °	Opsiyon Kodu / Option Code			
	(G)	(A)	Sürücü Uzunluğu Slider Length	Sürücü Genişliği Slider Width	---	---
ACKSK -	58	- 00				
ACKSK -	58	- 20	- SU50			
ACKSK -	58	- 35	- SU30	- SG60		

ACKSK-58 Teknik Bilgiler / Technical Informations

Çalışma Yüzeyi/Mounting Surface		Çalışma Açısı Work Angle (°)	Kam Kuruşu/Cam Travel Stroke (mm)	Çalışma Kuvveti Working Force	Yay Kuvveti Spring Force	Gazlı Yay Kuvveti Gas Spring Force (Opsiyon/Option)
(G)	(Gh)	(A)	(S)			
58	70	00	21,2	300.000 Baskı/Stroke 68,6 kN (7,0 tonf)		6610 N (674 kgf)
58	70	05	23,4			6607 N (674 kgf)
58	70	10	25,7			6604 N (673 kgf)
58	70	15	28,0			6601 N (673 kgf)
58	70	20	30,4			6598 N (673 kgf)
58	70	25	33,0			6594 N (672 kgf)
58	70	30	35,8			6591 N (672 kgf)
58	70	35	38,9			6587 N (672 kgf)
58	70	40	42,4			6583 N (671 kgf)
58	70	45	46,5			6580 N (671 kgf)
58	70	50	51,3	1.000.000 Baskı/Stroke 34,3 kN (3,5 tonf)		6576 N (670 kgf)
58	70	55	47,1			6675 N (681 kgf)
58	85	60	50,0			8017 N (817 kgf)
58	83	65	52,1			8750 N (892 kgf)
58	78	70	58,5			10158 N (1036 kgf)
58	80	75	58,0			12012 N (1225 kgf)
58	80	80	69,1			13896 N (1417 kgf)

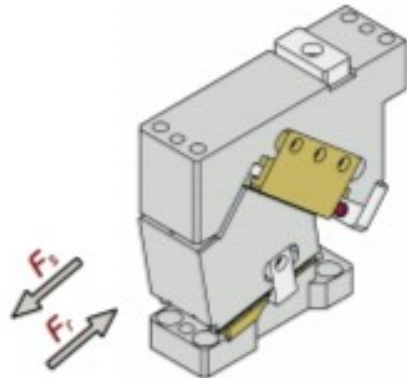
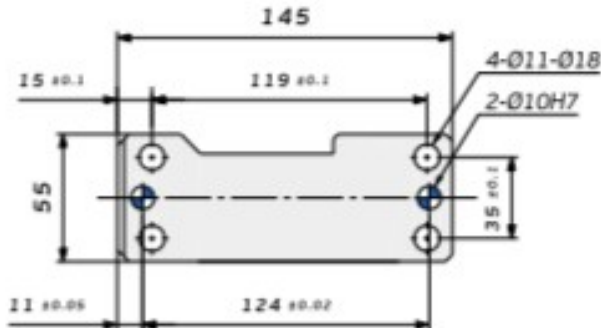
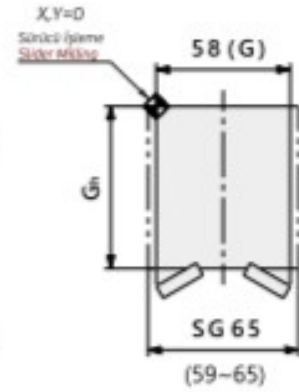
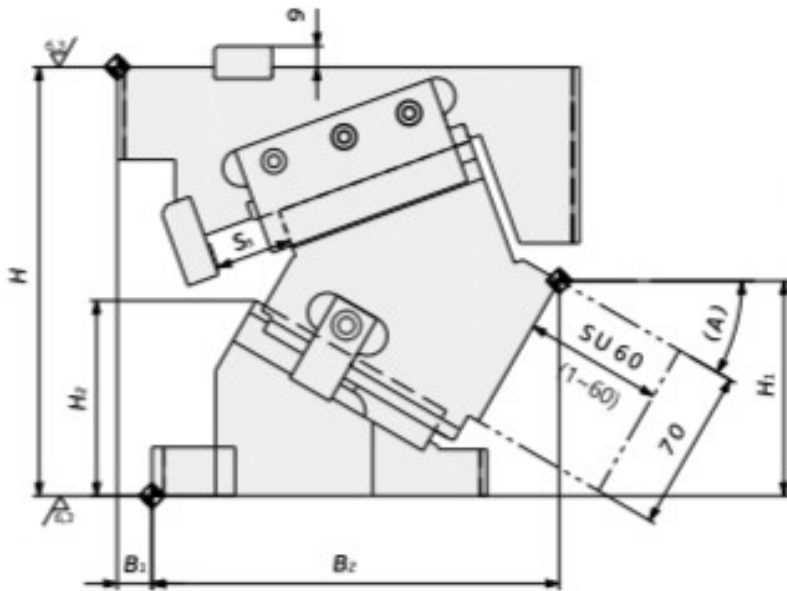
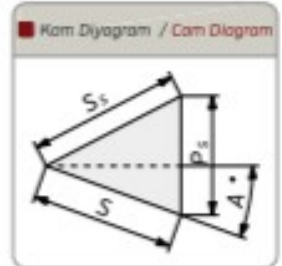
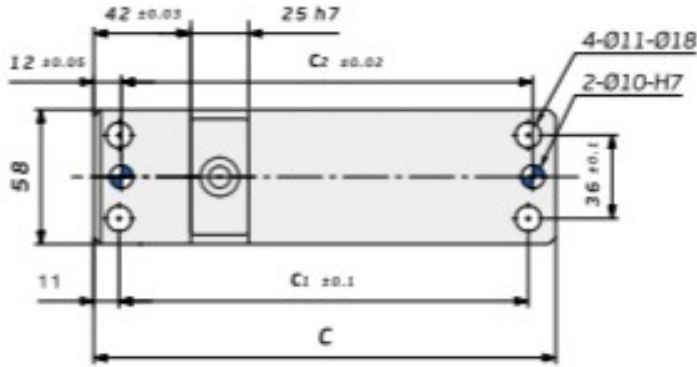

Kam Kodu Cam Kode	Açı Angle (A)	Ölçüler / Dimensions (mm)											
		S	Ps	Ss	H	H1	H2	B1	B2	C	c1	c2	Gh
ACKSK-58	00	21,2	25,3	33	185	119,0	46,0	49	138,0	185	162	163	70
ACKSK-58	05	23,4	25,4	33	185	114,3	51,1	45	145,7	190	167	168	70
ACKSK-58	10	25,7	25,7	33	185	109,6	56,8	41	152,3	195	172	173	70
ACKSK-58	15	28,0	26,2	33	185	105,2	63,3	34	159,5	195	172	173	70
ACKSK-58	20	30,4	26,9	33	185	100,8	69,9	29	165,6	200	177	178	70
ACKSK-58	25	33,0	27,9	33	185	96,7	77,0	22	171,5	200	177	178	70
ACKSK-58	30	35,8	29,2	33	185	92,7	84,2	15	176,2	200	177	178	70
ACKSK-58	35	38,9	30,9	33	185	89,0	92,3	8	180,8	200	177	178	70
ACKSK-58	40	42,4	33,0	33	185	84,5	98,8	0	185,2	200	177	178	70
ACKSK-58	45	46,5	35,8	33	185	81,2	107,3	-12	177,4	195	172	173	70
ACKSK-58	50	51,3	39,3	33	190	74,1	111,5	-23	170,6	190	167	168	70
ACKSK-58	55	47,1	38,6	27	205	81,8	114,9	-31	172,3	190	167	168	70
ACKSK-58	60	50,0	43,3	25	210	84,1	119,1	-44	169,7	190	167	168	85
ACKSK-58	65	52,1	47,2	22	215	85,4	121,2	-56	164,1	190	167	168	83
ACKSK-58	70	58,5	55,0	20	215	83,3	125,4	-66	160,7	190	167	168	78
ACKSK-58	75	58,0	56,0	15	215	80,1	126,8	-77	159,4	190	167	168	80
ACKSK-58	80	63,3	62,4	11	215	77,4	132,1	-89	155,4	190	167	168	80

 ORDER	Kod / Code	(G)	(A)	Opsiyon / Option
	ACKSK	58	10	SU30-SG60