

ACKSK-46 Bilgilendirme / Information

- Çalışma Kuvveti / Working Force : (300.000 Baskı/Stroke) 49,0 kN (5,0 tonf)
- Sürücü Genişliği / Slider Width : 46 mm
- Çalışma Açısı / Work Angle : 0° - 80°
- SU Opsiyonu / SU Option : 1-60 mm
- Sipariş Örneği / Order Example : ACKSK-46-30-SU40

Kam Diyagramı / Cam Diagram

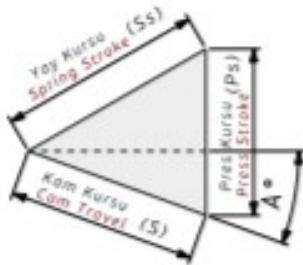

Sipariş Örneği / Order Example

Kam Kodu Cam Code	Sürücü Genişliği Slider Width (mm)	Çalışma Açısı Work Angle (°)	Opsiyon Kodu / Option Code		
			Sürücü Uzunluğu Slider Length	---	---
ACKSK - 46 - 00					
ACKSK - 46 - 20 - SU10					

ACKSK-46 Teknik Bilgiler / Technical Informations

Çalışma Yüzeyi/Mounting Surface		Çalışma Açısı Work Angle (°)	Kam Kuruşu/Cam Stroke (mm)	Çalışma Kuvveti Working Force	Yay Kuvveti Spring Force	Gazlı Yay Kuvveti Gas Spring Force (Opsiyon/Option)
(G)	(Gh)					
46	68,5	00	20,6	300.000 Baskı/Stroke 49,0 kN (5,0 tonf)		3862 N (394 kgf)
46	68,5	05	22,7			3861 N (393 kgf)
46	68,5	10	24,9			3859 N (393 kgf)
46	68,5	15	27,1			3857 N (393 kgf)
46	68,5	20	29,5			3855 N (393 kgf)
46	68,5	25	32,0			3852 N (392 kgf)
46	68,5	30	34,7			3850 N (392 kgf)
46	68,5	35	37,7			3848 N (392 kgf)
46	68,5	40	41,1			3846 N (392 kgf)
46	68,5	45	45,1			3843 N (392 kgf)
46	68,5	50	49,8	1.000.000 Baskı/Stroke 24,5 kN (2,5 tonf)		3841 N (391 kgf)
46	83,5	55	45,3			3928 N (400 kgf)
46	75	60	46,0			4709 N (480 kgf)
46	75	65	47,3			5073 N (517 kgf)
46	75	70	49,7			5594 N (570 kgf)
46	75	75	50,2			7092 N (723 kgf)
46	80	80	57,6			8575 N (874 kgf)

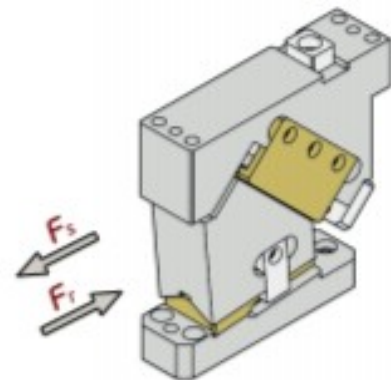
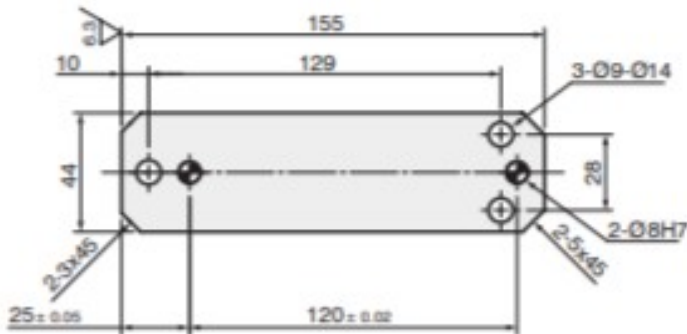
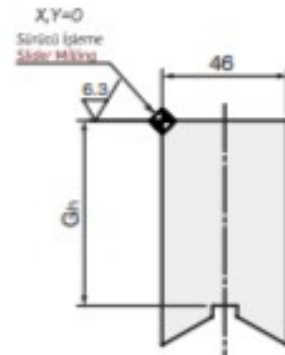
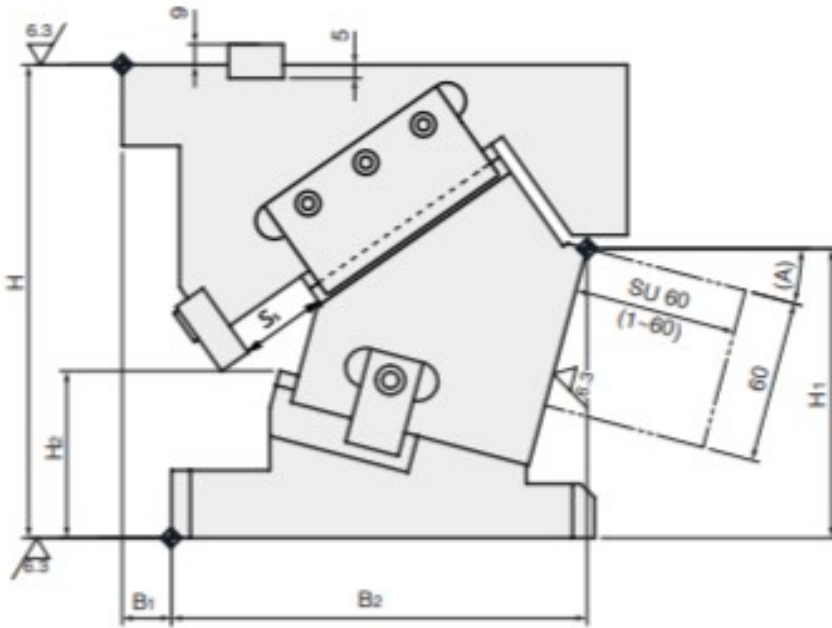
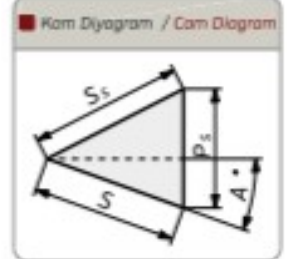
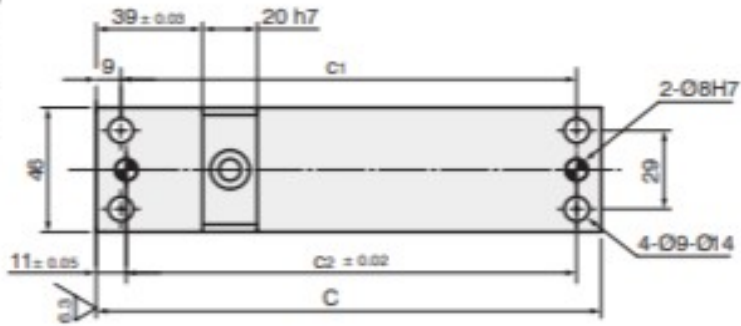

Kam Kodu Cam Kode	Açı Angle (A)	Ölçüler / Dimensions (mm)											
		S	P _s	S _s	H	H ₁	H ₂	B ₁	B ₂	C	c ₁	c ₂	G _h
ACKSK-46	00	20,6	24,5	32	175	118,0	45,2	28	132,0	170	152	150	68,5
ACKSK-46	05	22,7	24,6	32	175	114,6	50,6	25	138,9	175	157	155	68,5
ACKSK-46	10	24,9	24,9	32	175	110,2	55,4	22	145,7	180	162	160	68,5
ACKSK-46	15	27,1	25,4	32	175	107,0	61,8	18	152,3	185	167	165	68,5
ACKSK-46	20	29,5	26,1	32	175	103,9	68,7	12	158,9	185	167	165	68,5
ACKSK-46	25	32,0	27,0	32	175	100,9	76,0	6	164,3	185	167	165	68,5
ACKSK-46	30	34,7	28,3	32	175	98,1	84,6	-2	170,7	185	167	165	68,5
ACKSK-46	35	37,7	29,9	32	175	95,4	92,6	-9	176,0	185	167	165	68,5
ACKSK-46	40	41,1	32,0	32	175	91,9	102,3	-21	185,3	185	167	165	68,5
ACKSK-46	45	45,1	34,7	32	175	89,5	112,3	-28	190,5	185	167	165	68,5
ACKSK-46	50	49,8	38,1	32	180	86,3	119,9	-38	194,7	180	162	160	68,5
ACKSK-46	55	45,3	37,1	26	185	82,2	109,6	-45	206,2	180	162	160	83,5
ACKSK-46	60	46,0	39,8	23	190	78,2	112,2	-50	207,8	180	162	160	75,0
ACKSK-46	65	47,3	42,9	20	195	81,3	115,2	-62	217,2	180	162	160	75
ACKSK-46	70	49,7	46,7	17	195	79,5	118,6	-73	225,4	180	162	160	75
ACKSK-46	75	50,2	48,5	13	195	77,6	120,6	-84	235,4	180	162	160	75
ACKSK-46	80	57,6	56,7	10	195	76,6	126,1	-94	244,8	180	162	160	80

 ORDER	Kod / Code	(G)	(A)	Opsiyon / Option
	ACKSK	46	40	SU50

